

### Insulation:

U-value 0.72-0,78 W/m<sup>2</sup>K

### Sound insulation:

With sound reduction glass  $R_w = 42$  dB  $C_{tr} = 37$  dB

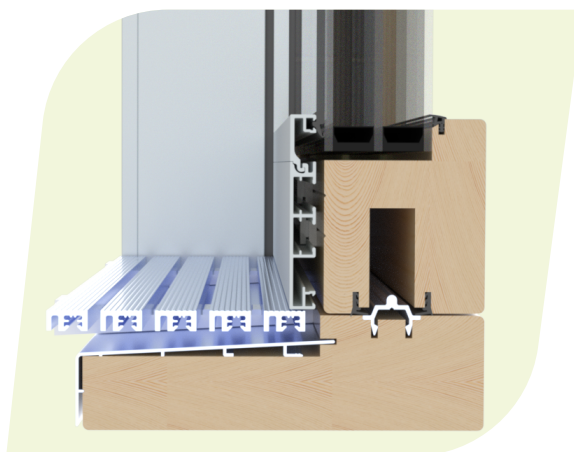
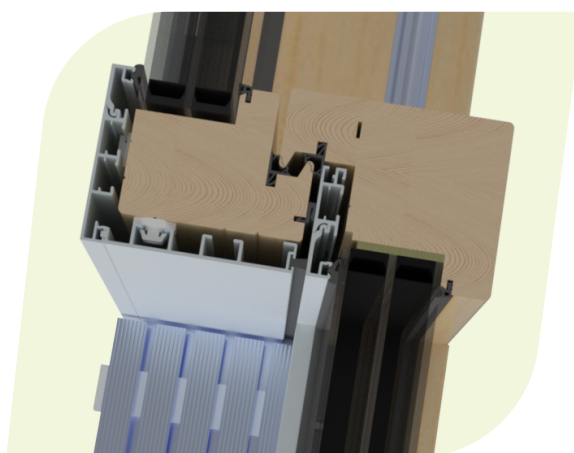

This is the Easy Flow wood-aluminium parallel sliding door – the best combination of aesthetic design and practical functionality. Easy Flow is long-lasting, energy-efficient, and easy to install. The sliding door provides convenient access to the garden, terrace, or balcony, and opens the room to light and fresh air. Our Easy Flow sliding doors are available in a range of different styles and finishes, allowing you to find exactly what suits the interior of your home. Enquire about the different available options (e.g. flush threshold, fly screen door, etc.).

## TECHNICAL SPECIFICATIONS

Air Permeability 4  
Wind Resistance class C4  
Water Resistance 8A

## WOOD

Pine wood is selected and processed according to the quality standard RT 103241. Sliding door jambs are made of at least three layers of glued laminated timber (pine) and glued with weather-resistant adhesive D4. Sliding door frames are made of knotless pine and the visible stained/varnished surface is free of finger joints.

## ALUMINIUM

The weatherproof and easy to maintain aluminium parts are powder coated or anodised. Available in a wide range of colours, ask for more information.

## FITTINGS

The standard colour of the handle (GU) is silver, but there are also options in black, brown, bronze, titanium, brass, and white. The handle can be selected to be key-less, opened with a turn knob on the inside and a key on the outside, or opened on both sides with a key.

## DIMENSIONS AND SHAPE

Jamb depth 211mm.  
The maximum weight of an opening door leaf is 600kg.  
Jamb height 1,339–3,200 mm  
Jamb width 1,600–10,000 mm

## GLASS

The standard package includes triple glazed windows with improved properties according to the SFS standard. 3K 6SEL.KAR/4/6 SEL.KAR-18 CU+ARG. Thickness of the insulating glass unit 52mm. Strip width 18mm. Custom-made safety glass, insulating glass units to improve acoustic insulation and reduce the effects of solar radiation

## SURFACE FINISHING

Wood details are coated in our factories with weatherproof paints, stains or lacquers (AkzoNobel, TINTEX). There are a wide range of colour options.

## SEALS

We use high quality EPDM and PU seals to keep your home warm in winter and cool in summer.

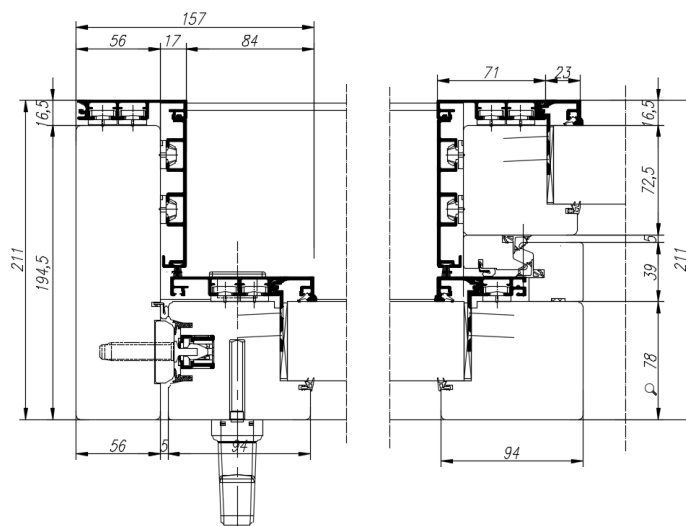
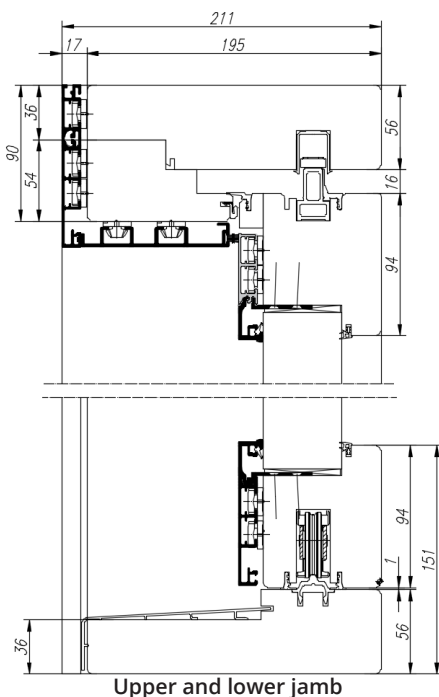

Possible patterns

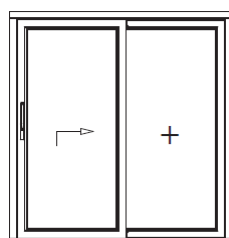

Pattern A

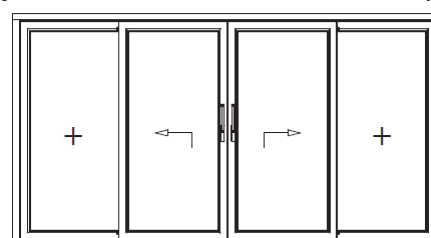

Pattern C