

Insulation:

U-value with standard glass 0,78 W/m²K

Sound insulation:

Standard glass $R_w = 32 - 48$ dB

Ctr = 27-45 dB



Durable, energy efficient and easy to maintain **Fenestra Passive Fixed** windows are an excellent option for any home. This wood aluminium window does not open and comes with hardened triple selective glazing. The advantage of a non-opening window is that it enables the construction of large-scale windows. The architraves are covered with aluminium profiles. The windows can be ordered and fitted with venetian blinds and decorative edging. The model comes in a variety of finishing options. All our products are tested by approved test labs.

TECHNICAL SPECIFICATIONS

Airtightness 4
Resistance to wind load class C5
Impermeability E1050

test measure 1 230 x 1 480 (TÜV)

WOOD

Wood has been selected and processed based on quality standard RT 103241. Architraves are made of glued laminated timber (pine) with at least three layers using weatherproof glue D4.

ALUMINIUM

Weatherproof and easy-to-maintain aluminium parts are powder coated or anodized. There are a wide range of colour options, ask for further information.

SEALING

The aluminium profiles of the architrave are equipped with light grey or black sealant to protect against water and wind. The space between the glazing and the wooden architrave is filled with silicone.

DIMENSIONS AND SHAPE

Standard architrave depth options 128,5 mm, 168,5 mm and 208,5 mm.

Recommended area up to 6 m².

Larger dimensions available for special solutions.

GLASSES

The standard package includes triple glazing with improved properties that are compliant with SFS standard 3K4Sel/4/4Sel-18 CU+ARG.

Possibility to use glass packages up to 60 mm.

Possibility to order special safety glass, in order to improve the soundproofing of the glass package and to reduce the effects of solar radiation.

SURFACE FINISH

Wood details are coated in our factories with weather-proof paints, stains or lacquers (AkzoNobel, TINTEX). There are a wide range of colour options.

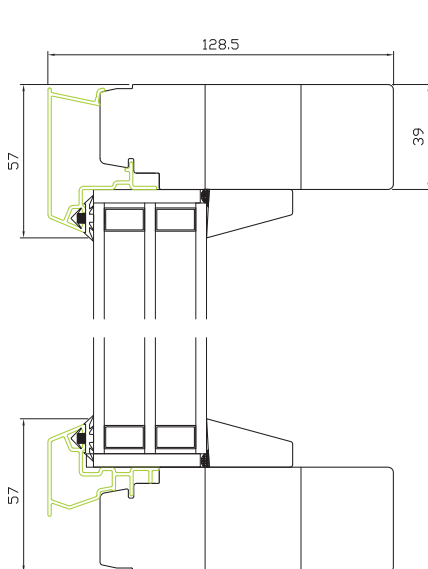

Upper and lower frame

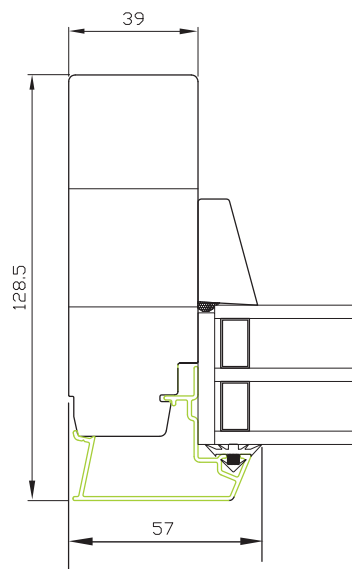

Side frame

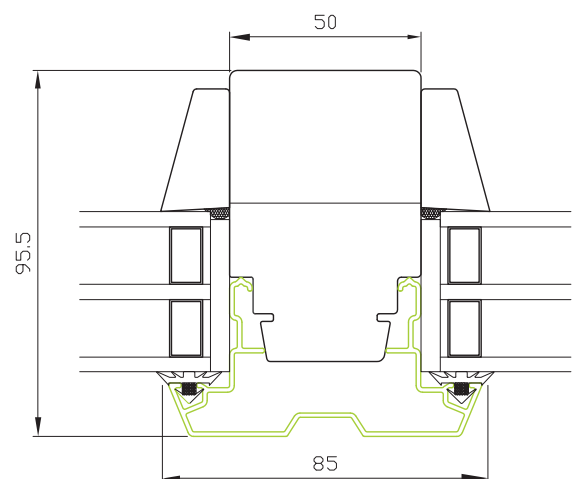

Vertical/horizontal impost